

ROLLING CODE RECEIVER

FA00067-EN

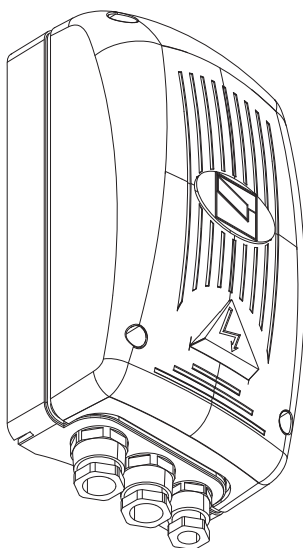

INSTALLATION AND OPERATION

RBE4RC

EN

English

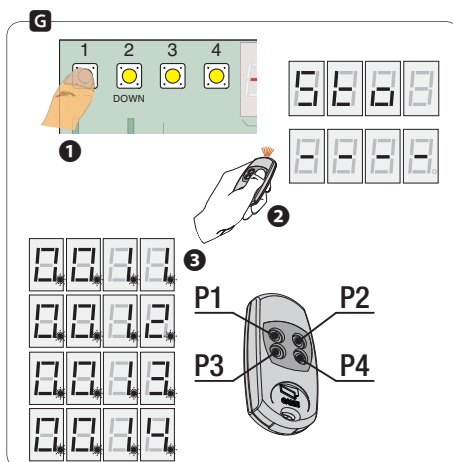
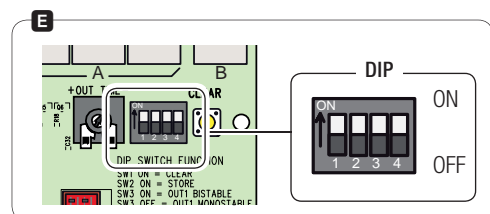
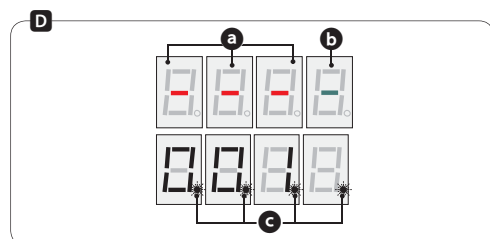
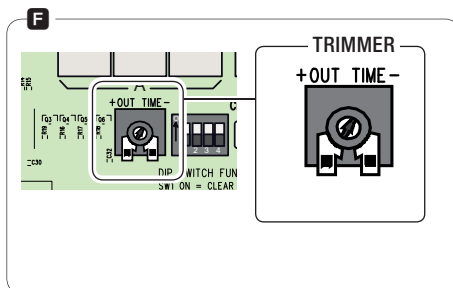
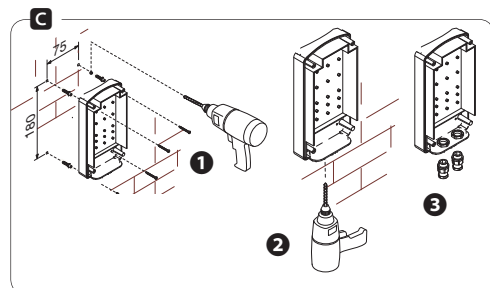
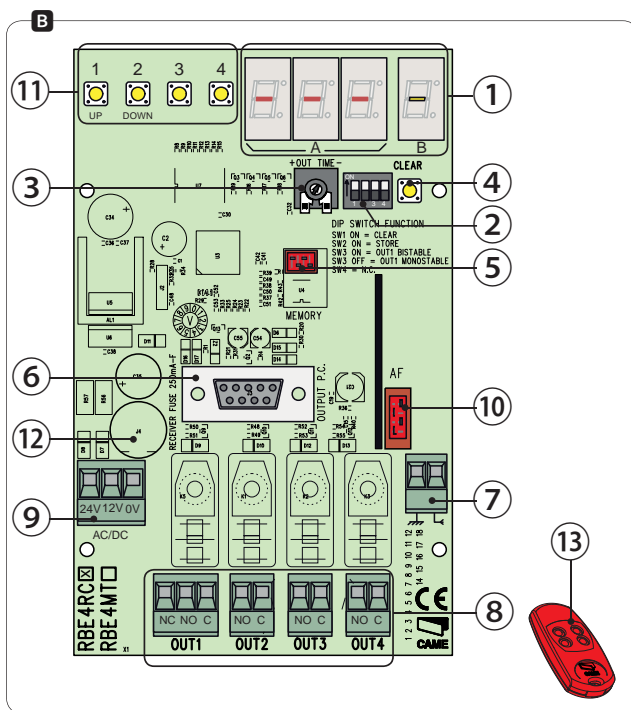
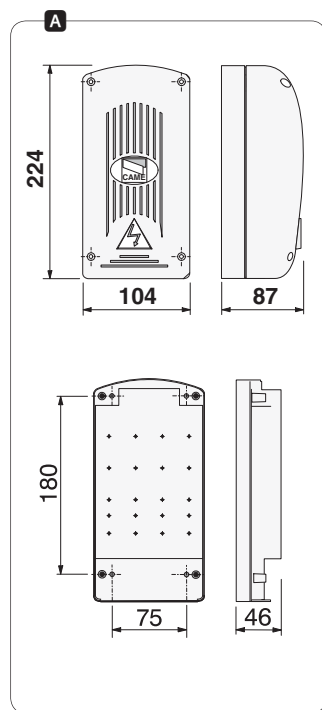

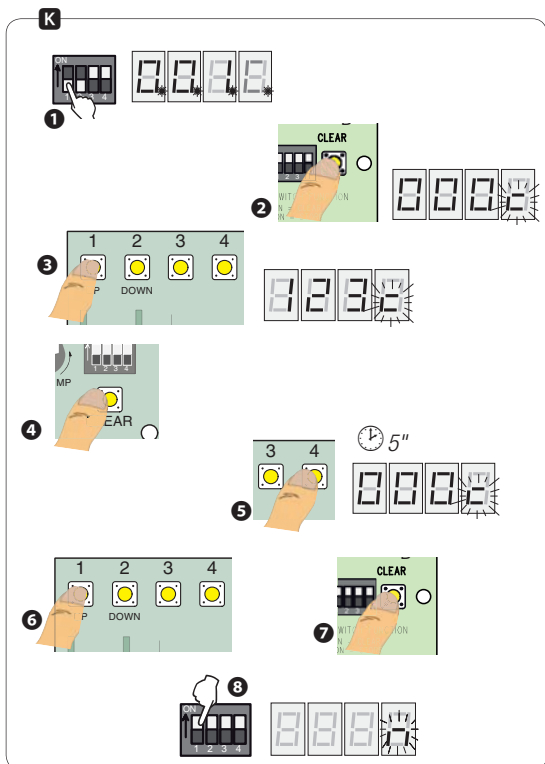
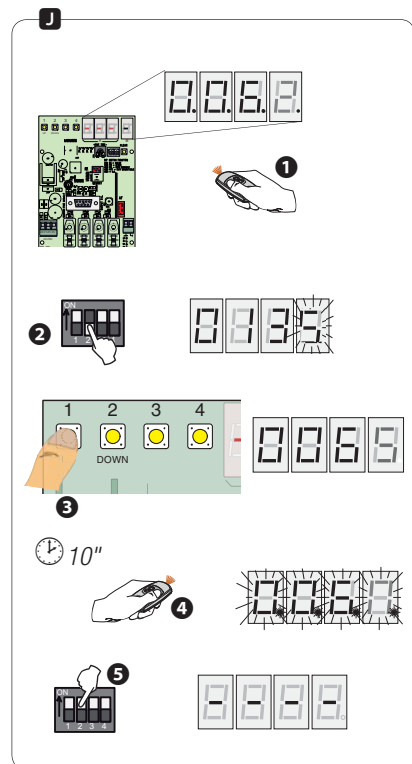
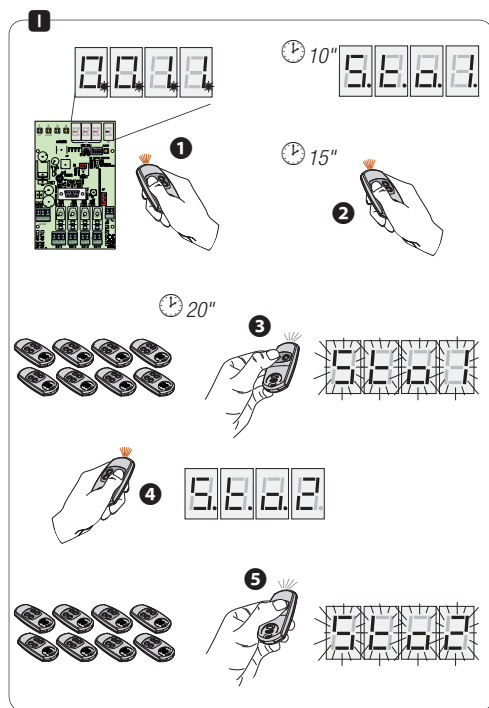
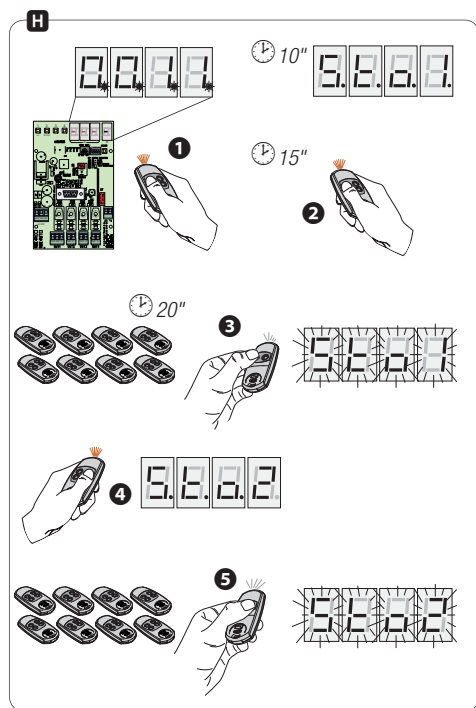

L

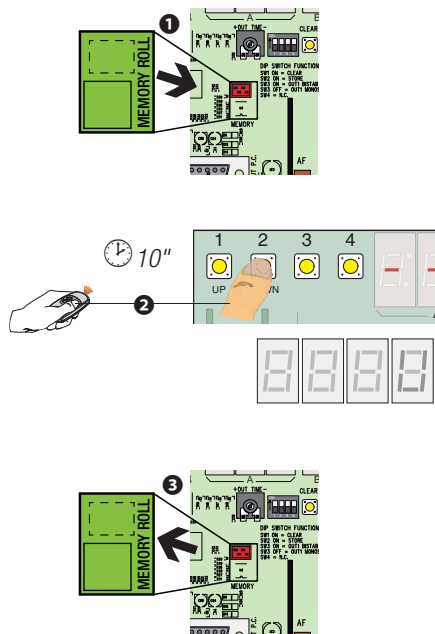

M

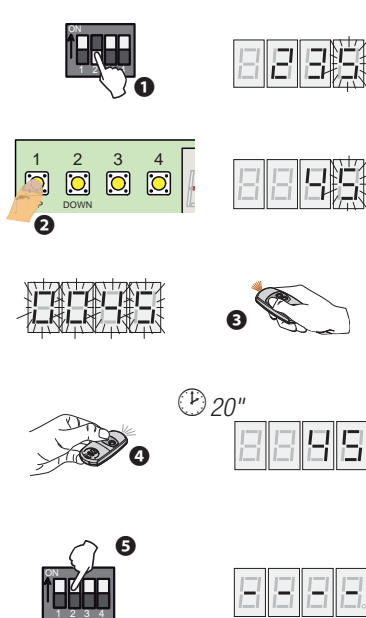

N

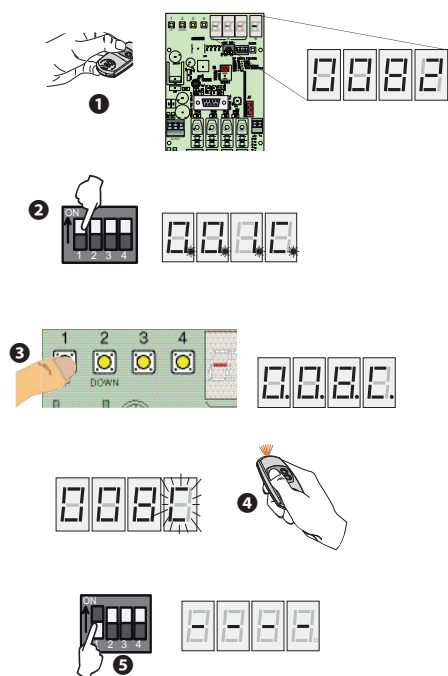

O

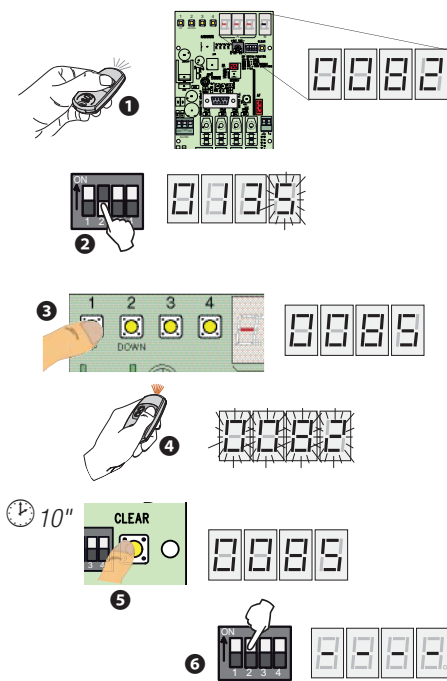

P

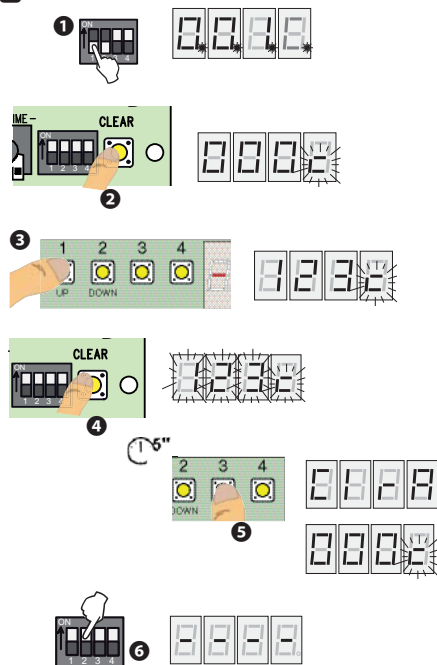

Q

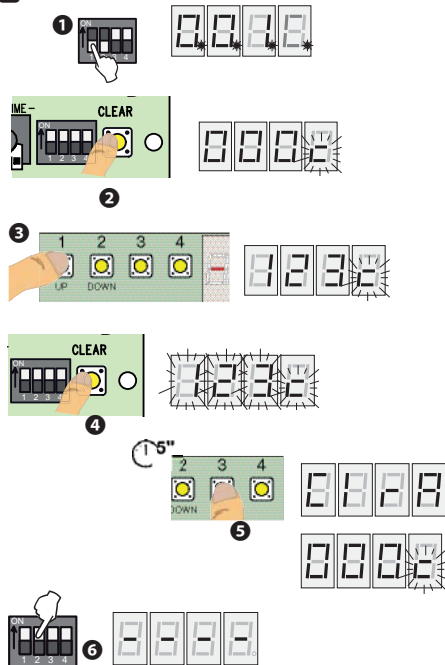

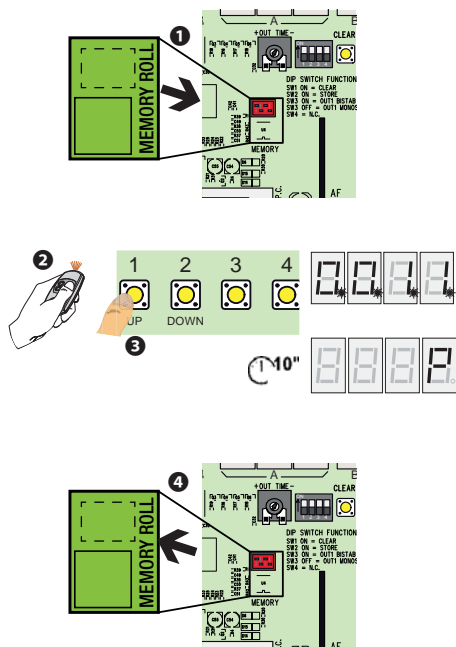

R

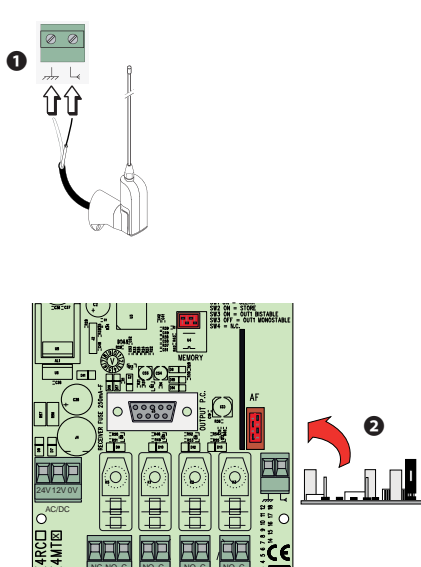

S



Legend

-  Parts to read carefully.
-  Parts about safety.
-  What to tell users.

REFERENCE REGULATIONS

Came S.p.A. is certified for the: ISO 9001 quality and ISO 14001 environmental management systems.
This product complies with the current regulations mentioned in the declaration of conformity.

DESCRIPTION

Four channel rolling code 433.92 or 868.35 MHz transmitter for memorizing up to 500 transmitters complete with one AT04 MASTER transmitter, with display and Memory Roll card.

The system can be programmed and managed by using the specific software (which can be requested) and a PC.

Limits to use

The minimum distance between receivers is 5 meters.
The antenna should be placed as high above the ground as possible and as far from any metal or reinforced concrete as possible.

Dimensions (mm)

Technical data

Type	
Protection rating (IP)	54
Power supply (V)	12 - 24 AC - DC
Power draw when idle (mA)	100
Power (W)	1.5
Insulation class	
Casing material	ABS
Operating temperature (°C)	-20 ÷ +55

Description of parts

1. Display
2. FUNCTIONS select Dip switch
3. Relay timer trimmer OUT 2
4. Reset button
5. Memory Roll card connector
6. RS232 connector for connecting to the PC
7. Antenna connection terminals
8. Device connection terminals (*)
9. Power supply terminals (**)
10. AF card connector
11. Programming buttons
12. 250 mA fuse
13. MASTER transmitter

- (*) Operators and/or accessories to control:
OUT1 in monostable or bistable mode.



OUT2 in monostable mode with timer adjustable from between 1 and 300 seconds.

OUT3 and OUT4 in monostable mode.



- (**) Cable type: FROR CEI 20-22 CEI EN 50267-2-1, 2 x 1 mm².

INSTALLATION

 Any installation and/or use other than that specified in this manual is forbidden.

Fasten the receiver's base to an impact protected area using suitable tools and equipment. .
Carefully perforate the pre-drilled Ø 20 mm holes . Fit the cable glands with the corrugated tubes for threading the electrical cables .

DISPLAY MESSAGES

-  Views the memory position of a transmitter.
-  During programming/maintenance operations, the associated OUT outputs are shown. At normal working conditions it indicates either the transmitter's channel / key. When it flashes it means that no transmitter is memorized on that particular output.
-  If the dots flash, the transmitter in that memory position is a MASTER transmitter.

 The default position of the MASTER transmitter is 001.
With this transmitter you can do all programming editing or restoring operations.

 Keep the MASTER transmitter with the Memory Roll card.

PROGRAMMING

 The following illustrations are merely examples.

Functions

DIP switches 1-2	Programming and maintenance
DIP switch 3 ON	Bistable relay on OUT 1
DIP switch 3 OFF	Monostable relay on OUT 1
DIP switch 4 OFF	Not used

Trimmer adjustments

OUT TIME: Adjusting OUT2 timer between 1 and 300 seconds.

MEMORIZING THE FIRST TRANSMITTER (MASTER)

The first memorized transmitter will be the MASTER. This transmitter enables you to perform all programming editing or restoring operations.

 Keep the MASTER transmitter with the Memory Roll card.

Press key 1: the display will read Sto 1.

Press and keep pressed any key on the MASTER transmitter: the wording will disappear on the receiver's screen.

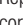
Repeat  and  for each of the receiver keys and corresponding Master transmitter KEYS: buttons 2, 3 and 4 with, keys P2, P3 e P4.

MEMORIZING TRANSMITTERS IN SEQUENTIAL MODE

- Press any key on the MASTER transmitter. After 10 seconds, the receiver's display will read Sto 1. Keep the key pressed until the LED stays on permanently.
- Within 20 seconds, press a key on the transmitter you want to memorize; the wording in the display will flash to show that memorization is now complete.
- Repeat **3** and **4** for all transmitters you wish to add.

Control several outputs simultaneously

The control of several operators/accessories connected to OUT1 and OUT2 can be associated to one transmitter button, even if they are separately associated with the MASTER transmitter.

MEMORIZING A SECOND MASTER TRANSMITTER

You can memorize a second MASTER transmitter among those you have already memorized in your receiver.

☞ If you repeat this procedure with another transmitter, it will replace any previous second MASTER transmitter.

- Press a key on the transmitter that you want to memorize as second MASTER transmitter. The display will show the position occupied by the transmitter.
- Set DIP switch 2 to ON. The display will show the first free position and a flashing S.
- Press 1 (UP) or 2 (DOWN) to select the position.
- Press and keep pressed the key of the first MASTER transmitter. The display will flash the position and the letter M.
- Set DIP switch 2 to OFF.

Edit Password

The (123) default password can be edited with a combination of between 1 and 500.

- Set DIP switches 1 and 2 to ON; The display shows 001 and C.
Press CLEAR; the display will flash 000 and C.
- Press 1 (UP) or 2 (DOWN) to select the default password.
- Press CLEAR; the display will flash 123 and C.
Within five seconds press button 4; the display shows both 000 and - flashing.
- Press 1 (UP) or 2 (DOWN) to setup a new password. Press CLEAR; the display will show M flashing.
- Set DIP switches 1 and 2 to OFF.

Saving data

You can save data on the Memory Roll.

- △ Cut off the main power supply every time you connect or disconnect the Memory Roll card.
- Fit the Memory Roll card into the connector.

- Power up and keep the Master transmitter's button MASTER BARRIER the receiver's 2 button pressed simultaneously until the letter U appears after about 10 seconds.
Release the key and button simultaneously.
The data is now transferred to the Memory Roll.
- Cut off the main power supply and remove the Memory Roll card.

Manually memorizing a transmitter

- Set DIP switch 2 to ON. The display will show the first free position and a flashing S.
- Press 1 (UP) or 2 (DOWN) to select a different free position. The S flashes only if the position you have selected is free.
- On the MASTER transmitter press the button that is associated with the output to which you want to add a transmitter; the output you have selected is displayed in flashing mode.
- Within 20 seconds press the button of the new transmitter you want to memorize; after a few seconds the displayed wording stops flashing to indicate that memorization has been successful.
- Set DIP switch 2 back to OFF again.

Deleting a transmitter

You can delete one or more transmitters.

- Press a key on the transmitter you want to delete to check which position it occupies in the receiver.
- Set DIP switch 1 to ON; the display shows 001 C and stays on permanently.
- With 1 UP and 2 DOWN, select the position of the transmitter that you want to delete.
- Press any key on the Master transmitter; a flashing C is displayed
- RESET DIP switch 1 to OFF.

Inhibiting the keys on one transmitter

You can inhibit one or more buttons on a transmitter, instead of deleting it.

- Press a button on the transmitter. The display shows which position is occupied.
- Set DIP switch 2 to ON. The display will show the first free position and a flashing S.
- Press 1 (UP) or 2 (DOWN) to select the position. The S on the display stays lit.
- Press the button on the transmitter you want to inhibit. The writing on the display starts flashing.
- Within ten seconds press CLEAR; the occupied position is again displayed and remains lit.
- Set DIP 2 to OFF.

Completely deleting the programming

- Set DIP switch 1 and then DIP switch 2 to ON; the display will show 001 and C.
- Press CLEAR; the letter C will flash.
- Press 1 UP or 2 DOWN to enter the password.
- Press CLEAR; the password and the letter C will flash. Within five seconds press button 3; the display will flash CLr and also the letter A and then 001 and the letter C. The memory is empty.
- Reset DIP switch 1 and 2 to OFF.

Restoring the Memory Roll programming

- △ To restore the programming, memorize a transmitter such as the MASTER and then recover the Memory Roll card data.
- △ Cut off the main power supply every time you connect or disconnect the Memory Roll card.
- Fit the Memory Roll card into the connector.
- Power up and keep simultaneously pressed the key on the MASTERtransmitter and button 1 on the receiver. Within 10 seconds, the letter P will appear on the display. Release the key and button simultaneously. The data have been stored in the receiver.
- Cut off the main power supply and remove the Memory Roll card.

ACTIVATING THE RADIO CONTROL

- △ Cut off the main power supply.
- ① Connect the RG58 cable to the antenna.
- ② Fit the AF card into the receiver.

 The receiver recognizes the AF card only when the power is back on.

Frequency / MHz	Card	Transmitter
AM 433.92	AF43S	TAM / TOP / TWIN
AM 868.35	AF868	TOP

DISMANTLING AND DISPOSAL

Always make sure you comply with local laws before dismantling and disposing of the product.
DO NOT DISPOSE OF IN NATURE!

The contents of this manual may be changed at any time without prior notice.

DECLARATION OF CONFORMITY

**Declaration 



*An original copy is available on request.***

CAME
safety & comfort





Came S.p.A.

Via Martiri Della Libertà, 15
31030 **Dossan di Casier**
Treviso - Italy

 (+39) 0422 4940
 (+39) 0422 4941

Via Cornia, 1/b - 1/c
33079 **Sesto al Reghena**
Pordenone - Italy

 (+39) 0434 698111
 (+39) 0434 698434

www.came.com