



FA00104M4A

RIO-EDGE



IT Italiano  
EN English  
FR Français  
RU Русский

www.came.com

**CAME**  
safety&comfort

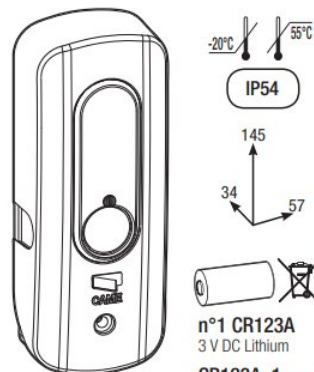

n°1 CR123A  
3 V DC Lithium  
CR123A, 1 шт.  
=3 В, литиевые

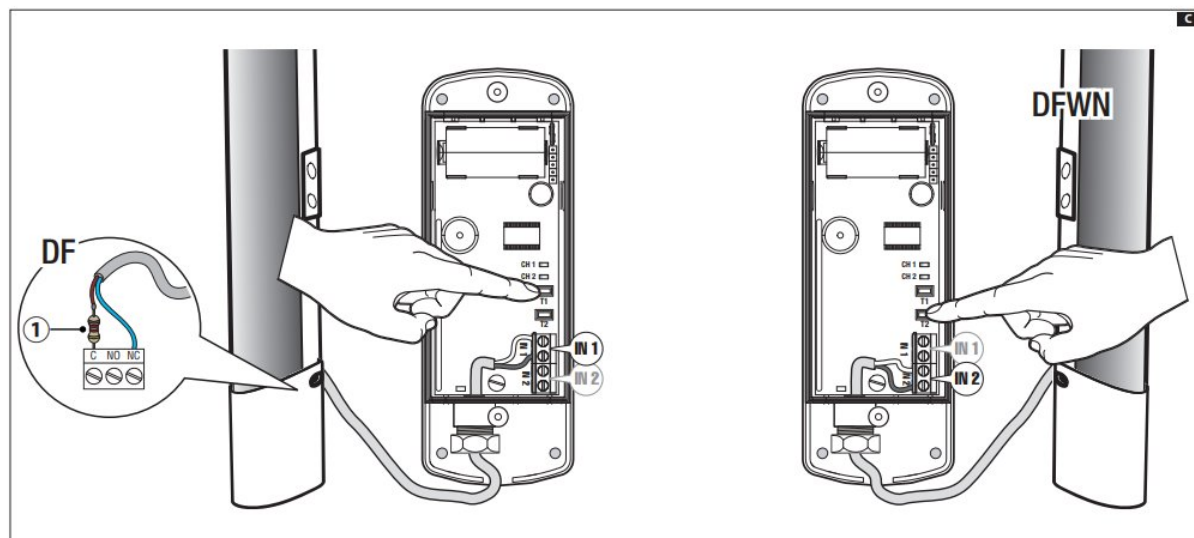
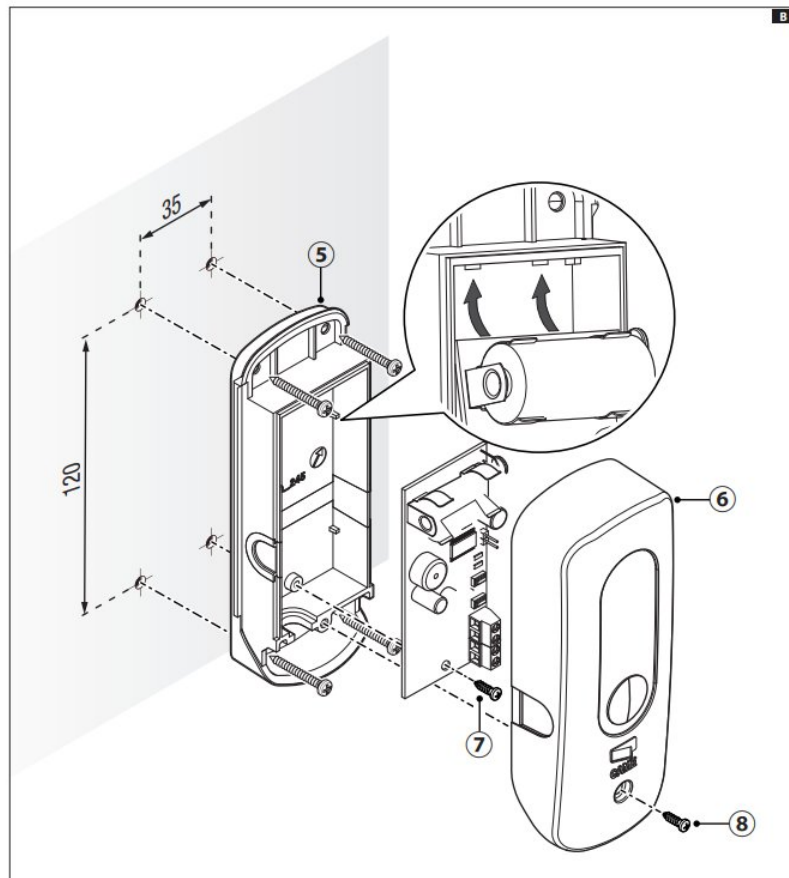
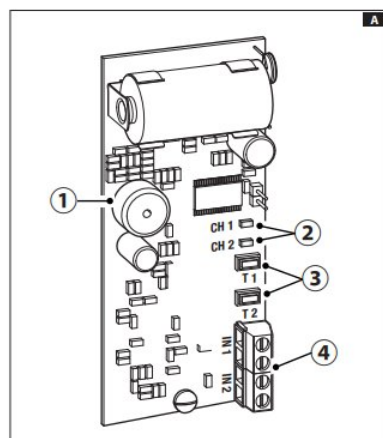

## ENGLISH

## Description

Wireless module for controlling either one or two 8.2 KΩ, DF-W series resistive sensitive safety-edges, that are communicating with their corresponding Rio-Control device; or with RIO-CONN. Comes with flat-battery or radio-malfunction warning buzzer.

## Main control-card components A

- ① Buzzer
- ② CH1 and CH2 warning LED
- ③ Programming buttons T1 and T2.
- ④ Terminals for connecting the sensitive safety-edges

## Main casing components B

- ⑤ Casing base
- ⑥ Casing cover
- ⑦ Card-fastening screw
- ⑧ Shell-fastening screw

## Technical data

Type	RIO-EDGE
Power supply (V DC)	3
Stand-by absorption (µA)	80
Transmission absorption (mA)	15
CR123A lithium battery (mAh)	1700
Battery life (months)	*24
Radio frequency (MHz)	868.95 - 869.85
Radio range over clear areas (m)	30 max.
Infrared range (m)	10
Materials	PC-ABS

\* The battery duration is calculated on an yearly average of 20 openings per day.

## Installation

- Fasten the bases ⑤ of the RIO-EDGE to the chosen surface.
- Fit the card into the corresponding housings in the casing ⑥ and fasten using the screws ⑦.
- Connect the DF-W sensitive safety-edges to the corresponding terminals ④.

If the edge/s are non RESISTIVE, such as those on the DF series) you will have to connect up the supplied 8.2 KΩ resistor ①.

- Memorize the devices in the Rio-Control or RIO-CONN CONTROL card (see the corresponding procedure).
- Test to see if it works (see control card instructions).
- Close the casings by hooking the cover from the top and fastening it with the supplied screw ⑧.

## Memorizing

## Remove any batteries from all the accessories.

- Fit the battery only into the device you are going to memorize and check that the CH1 and CH2 LEDs are flashing red - otherwise do a Reset (see the corresponding procedure).

- Press the PROG button, for two seconds, on the Rio-Control CARD or RIO-CONN: the wireless LEDs stop flashing red and just stay on. On RIO-EDGE the CH1 and CH2 LEDs go from flashing red to flashing blue. Once memorizing is complete, they switch off.

If you are memorizing RIO-EDGE fitted with the sensitive safety-edge connected to IN 1, press T1 for 2 seconds - when the LEDs switch off, memorization will be complete. If you wish to pair a second sensitive safety-edge to the just memorized RIO-EDGE, connect it to IN 2, press T2 for 2 seconds - when the LEDs switch off, memorization will be complete.

If you are memorizing RIO-EDGE fitted with the sensi-

tive safety-edge connected to IN 2, press T1 for two seconds - when the LEDs switch off, memorization will be complete. If you wish to pair a second sensitive safety-edge to the just memorized RIO-EDGE, connect it to IN 1, press T1 for two seconds - when the LEDs switch off, memorization will be complete.

PS: Keep the batteries fitted, once you have finished memorizing.

## Maintenance

Clean device with a damp cloth; do not use solvents.

## Reset procedure

- Keep pressed button T2 for about 10 seconds, until the red CH1 and CH2 LEDs flash red.

Each time you add or replace a device, you will have to reset the card and again memorize all the system devices.

## Troubleshooting

See paragraph: Troubleshooting the RIO-CONTROL or RIO-CONN device.

## Replacing the battery

△ Only replace with the same or equivalent batteries.

△ Keep the batteries away from children's reach. If swallowed, seek immediate medical attention.

△ The supplied battery's life also depends on its storage time. Fit the batteries when memorizing.

## Pertinent Regulations.

RIO-EDGE paired with RIO-CONTROL and together with an operator (or a control panel) with enabled safety test, is a safety device (EN 954-1).

RIO-EDGE paired with RIO-CONN, is a Category 2 safety device (EN 954-1).

△ Modifying the project or set up of the device, without first checking with the manufacturer or authorized dealer, may be hazardous.

Once installed, check compliance with the applicable parts of the following regulations: EN 13241-1, EN 12453, EN 12445.

Came S.p.A. is not liable for any damage caused if the product is used improperly, wrongfully or unreasonably.

**Declaration CE.** Came S.p.A. hereby declares that this device complies with the essential requirements and other pertinent provisions established in regulation 2006/95/CE, 199/5/CE. An original copy is available on request.

**Decommissioning and disposal.** - Do not dispose of the packaging and the device, at the end of its life cycle, in nature, but rather dispose of them by following the applicable laws in the country where the device is installed. The recyclable components all bear a symbol to that effect.

THE DATA AND INFORMATION IN THIS MANUAL MAY BE CHANGED AT ANY TIME AND WITHOUT NOTICE. THE MEASUREMENTS, UNLESS OTHERWISE STATED, ARE IN MILLIMETERS.



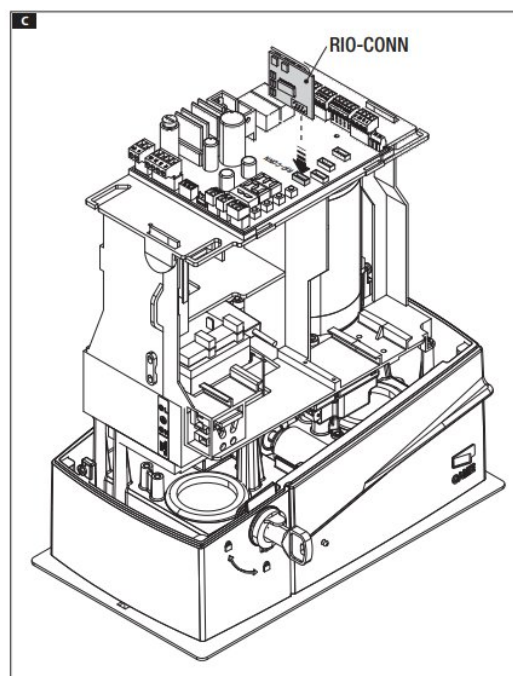
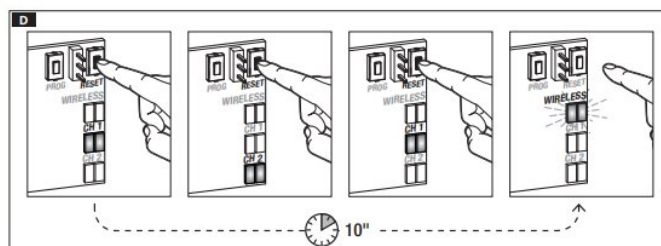
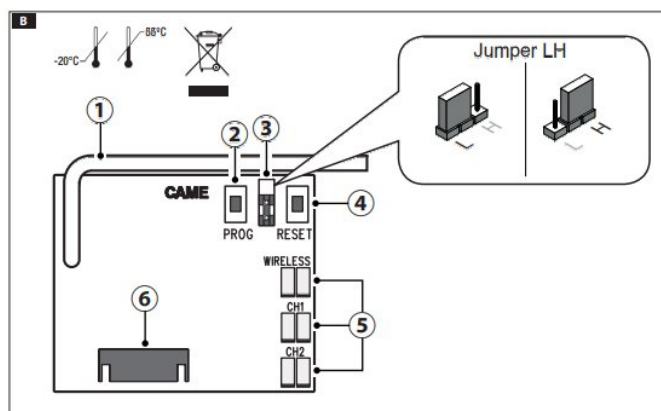
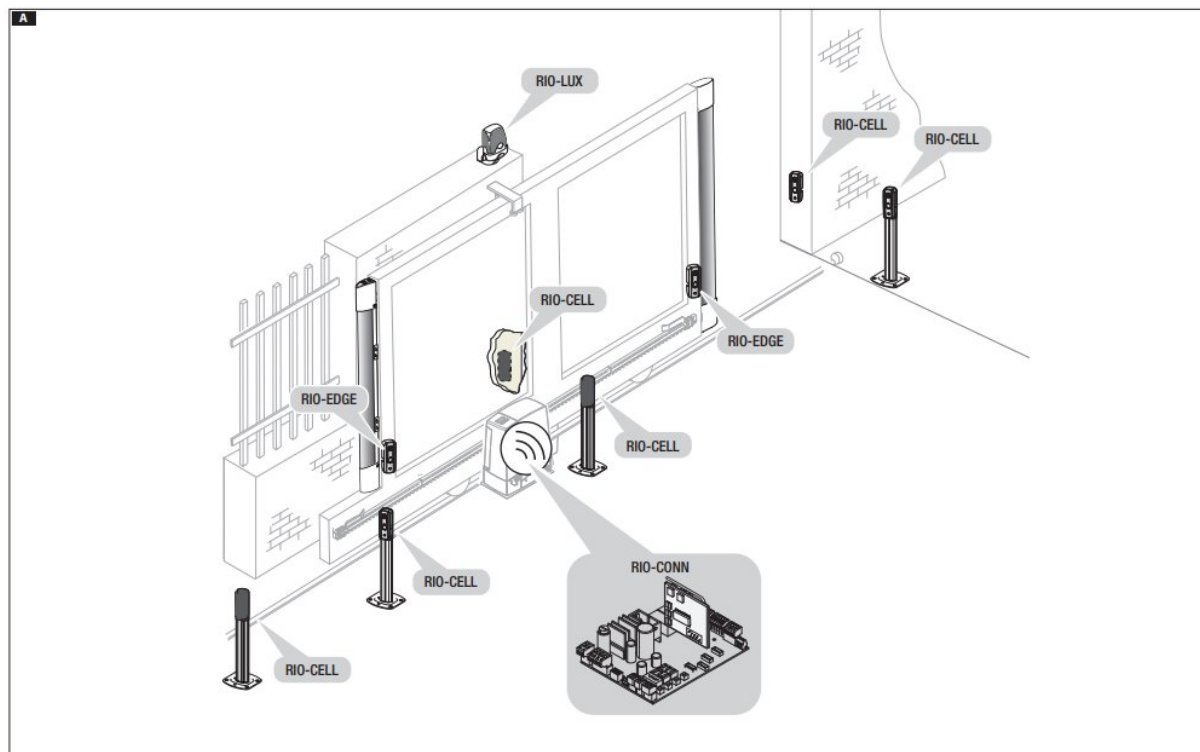

# ENGLISH

## Description

Control card for managing up to 10 Rio-wireless series accessories.  
It fits all operator control-boards or control-panels fitted with the corresponding connector. Figure A shows nine units - all interfacing with Rio-Conn.

## Main components B

- 1 Antenna.
- 2 Programming button.
- 3 Radio power-range selector switch.
- 4 Reset button.
- 5 Warning LED.
- 6 Socket for corresponding plugs.

## Technical data

Type	RIO-CONN
Maximum draw (mA)	25
Radio range over clear areas (m)	30 max.
Frequency (MHz)	868.95 - 869.85

## Installation

⚠ Before continuing, cut off the MAINS POWER SUPPLY and disconnect any batteries.

- Fit Rio-Conn onto the operator's control board C.

NB: Do not change the antenna's position.

- Power up the operator and check that the blue wireless LEDs are flashing.
- If they are not flashing, reset the card (see corresponding procedure).
- Remove batteries from the accessories.
- Memorize each single system component (see accessories' instructions)
- Test system's functionality (see corresponding procedure)

## Card resetting D

Keep RESET button pressed for about 10 seconds. The wireless LEDs flash.

NB: Replacing a device means that you will have to reset the card and again memorize all the devices on the system.

## Functional checks

Press a command button (each Rio accessory flashes\* blue)

Check that Rio-Lux activates.

Obstruct the gate's action and check whether the Rio-Cell and/or Rio-Edge devices actually activate prescribed safety function.

When the maneuver ends, each Rio accessory will flash\* red and then go into Low Power mode to preserve the batteries.

⚠ NB: In Low-Power mode, the manual test response time (that is, the flashing blue LED), will be slower.

\* If this does not happen, cut off the mains power supply and increase the radio signal's range/power by setting the jumper 3 to position H.

## Troubleshooting

■ LED stays on, □ LED is off, ▣ LED flashes

LED	Possible causes	Fix
■	No Rio accessory is memorized.	Configure Rio accessories.
□	The sensitive safety-edge connected to IN1 on RIO-EDGE fails to intervene.	Check settings and adjustments on the sensitive safety-edge.
□	The sensitive safety-edge connected to IN2 on RIO-EDGE fails to intervene.	Check settings and adjustments on the sensitive safety-edge.
▣	The Rio-Cells memorized with T1: a. Detect an obstruction. b. Are misaligned. c. Have flat batteries.	a. Remove the obstruction. b. Align the photocells. c. Replace the batteries.
▣	The Rio-Cells memorized with T2: a. Detect an obstruction. b. Are misaligned. c. Have flat batteries.	a. Remove the obstruction. b. Align the photocells. c. Replace the batteries.
▣	RIO-EDGE or RIO-CELL is not communicating with RIO-CONN.	Check the radio-transmission efficiency. Make sure the batteries are charged.
▣	RIO-LUX flashes or more of the connected wireless devices are almost flat.	Check the status of the batteries on the connected wireless devices and replace them within 10 days.

If the RIO-CONN-related functions don't appear on the control panel, switch the panel off and on again.

**Pertinent Regulations.** RIO-CONN paired with RIO-EDGE is a class 2 safety device (EN 954-1).  
Once installed, check compliance with the applicable parts of the following regulations: EN 13241-1, EN 12453, EN 12445.  
Came S.p.A. is not liable for any damage caused if the product is used improperly, wrongfully or unreasonably.  
The product complies with the relevant directives in force.

**Decommissioning and disposal.** - Do not dispose of the packaging and the device in nature, at the end of its life cycle, but rather dispose of them by following the applicable laws in the country where the device is installed. The recyclable components all bear a symbol to that effect.

THE DATA AND INFORMATION IN THIS MANUAL MAY BE CHANGED AT ANY TIME AND WITHOUT NOTICE.  
THE MEASUREMENTS, UNLESS OTHERWISE STATED, ARE IN MILLIMETERS.